



2023

PENTAGRAMMA

Designed by Pitsou Kedem

Pentagramma is the new living system designed by Pitsou Kedem for MDF Italia, a design with a strong personality that interprets the concept of the day system with sophistication by focusing on the value of lightness. Surprisingly simple to compose and install, the design develops from an extruded aluminium panel fixed to the wall, on which various elements, containers or shelves are hung. Its name was inspired by its construction: the wall-mounted back panel to which the accessories are hung to create the composition looks like a music stave or pentagramma in Italian, on which the notes are written to compose a tune.

Extremely flexible and versatile, this system offers the possibility of reconfiguring the layout over time. Just a few elements are enough to obtain infinite combinations that fulfil different functions and situations of use, fitting seamlessly and with versatility into all residential and contract environments: in fact, it offers a valid storage solution for walls in the living area and office, but also for creating compositions in the sleeping area.

BACKEST

The wall-mounted panel, the load-bearing structure of the whole system, is made of 20 mm thick extruded aluminium and available in various lengths (L150, L200 and 2L50 cm).

The panels can be fixed to the wall using the aluminium bar provided, onto which the hidden panel brackets are hung. It can all be adjusted in three directions: horizontally, vertically and also frontally (sloping away from the wall).

The panels are completely covered in veneered wood, available in two finishes: bleached oak and Canaletto walnut. Horizontal wood grain. The panels can be placed side by side horizontally. Whereas vertically there must always be a 5-cm gap between one panel and another to allow for attachment of the shelf or open unit modules.

SHELVES

The shelves are made from a single piece of 8 mm thick extruded aluminium. A really simple intuitive system uses the cross-section of the shelves themselves to hang them on the wall-mounted panels so that the various modules can be arranged and positioned as required.

An anchoring system is provided for safety. The various modules are available in a liquid paint finish in matt colours: white, lead black and shadow grey. The shelves are available in only one height but in various lengths (L60, L90 and 1L20 cm).

The system is rounded out by a divider (left or right), designed to add movement to possible configurations.

OPEN STORAGE UNITS

The open units are available in only one height but in various lengths (L30, L60 and L90 cm). The L90 modules have an internal divider (right or left) that separate the space creating a partition, like the musical notes on a stave.

The materials used are extruded aluminium for the back of the units, while the rest of the structure is made of panels in medium density wood fibre, laminated with aluminium to increase the resistance and sturdiness of the unit.

All the open units are liquid painted in matt colours: white, lead black, shadow grey, burgundy red, English green, dune and blue to match the rest of the MDF Italia collection.

LED LIGHTING

The LED system can be ordered as an accessory to fit to the lower part of the wall-mounted panels. Each panel can be fitted with the LED bars and will be provided with its own junction box and power supply unit. Colour temperature 2700° K. Can be switched on/off using a remote control or dedicated app.

Abacus

back panel, wall-mounted panel

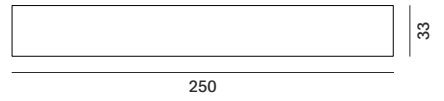
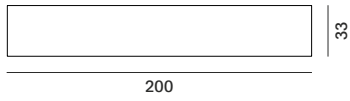
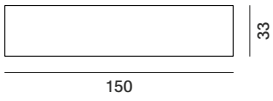

shelves



L60 D33 H34

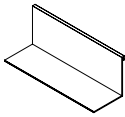

L90 D33 H34

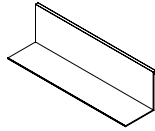

L120 D33 H34

shelves with L/R divider

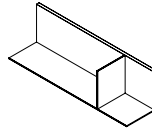

L120 D33 H34

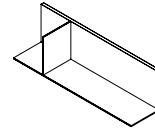

open unit



L30 D33 H34



L60 D33 H34

open unit with L/R divider

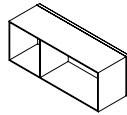

L90 D33 H34

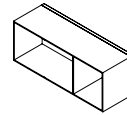

Finishing

The number in the dot corresponds to the number of colour/material finish.

Here below, in the section FINISH OPTIONS, please note all the colours of the materials used for this product.

SYSTEM

Structure

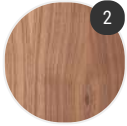

Wood

Shelves

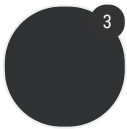

Matt painted

Open compartment

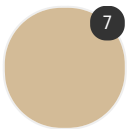

Matt painted

Finish options

STRUCTURE

Wood



Canaletto
walnut



Bleached oak
X075

SHELVES

Matt painted

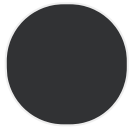

painted matt
lead black
X138



matt painted
shadow grey
X122

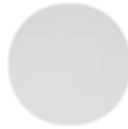

matt painted
white X053

OPEN COMPARTMENT

Matt painted

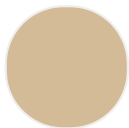

painted matt
dune



painted matt
burgundy



painted matt
navy blue

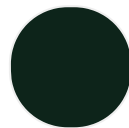

painted matt
English green

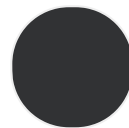

painted matt
lead black
X138



matt painted
shadow grey
X122

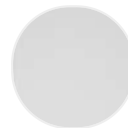

matt painted
white X053