

Steel

Year	2001
Designer	Lodovico Acerbis, Gabriele & Oscar Buratti

In a unique collaboration, award-winning designer Gabriele Buratti and Acerbis' own Lodovico Acerbis created the Steel sideboard unusually wide, emphasized by a minimalist structure that rests on two ephemerally thin side panels in mirror-polished steel, and bathed in light diffused by a matte methacrylate strip set into the top, with an illuminated interior and base as well.

Dimensions

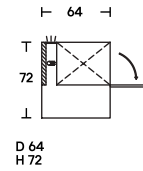
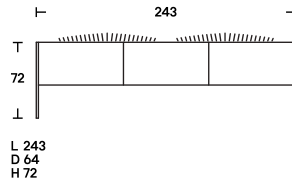
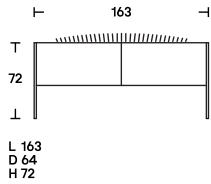

Finishes

Top and doors in matt or glossy lacquer in the colours: black, white, white SW, linen, sand, clay, burgundy, pink, dark green, mustard yellow, brick red and navy blue; dark-stained walnut veneer.

Sides in shiny mirrored AISI304 stainless steel.

Interiors in white microembossed finish.

Technical back-end system with back-lighting and cable organization.

Top and doors | Glossy lacquered

Glossy lacquered white	LL02
Glossy lacquered SW white	LL09
Glossy lacquered linen	LL10
Glossy lacquered sand	LL12
Glossy lacquered clay	LL15
Glossy lacquered mustard yellow	LL23
Glossy lacquered brick red	LL24
Glossy lacquered burgundy	LL20
Glossy lacquered pink	LL21
Glossy lacquered dark green	LL22
Glossy lacquered Navy blue	LL25
Glossy lacquered black	LL06

Top and doors | Matt lacquered

Matt lacquered white	L073
Matt lacquered SW white	L074
Matt lacquered linen	L075
Matt lacquered sand	L076
Matt lacquered clay	L081
Matt lacquered mustard yellow	L091
Matt lacquered brick red	L092
Matt lacquered burgundy	L088
Matt lacquered pink	L089
Matt lacquered Navy blue	L093
Matt lacquered dark green	L090
Matt lacquered black	L072

Top and doors | Wood

Dark stained walnut	ES59
---------------------	------

Sides

Shiny steel	MT01
-------------	------